

15.1 Curved shapes based on V-folds

The shape can be constructed as a V-fold and, although it looks very similar, it will fold away differently as the base closes. In this case the tabs that fix the shape to the base have to be moved from the middle of the outer edges to the corners, tabs **G**.

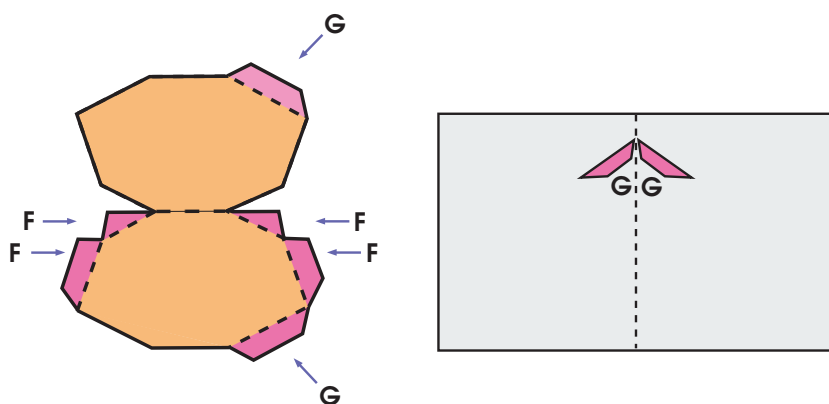

15.2 Simple Curved shape based on a V-fold

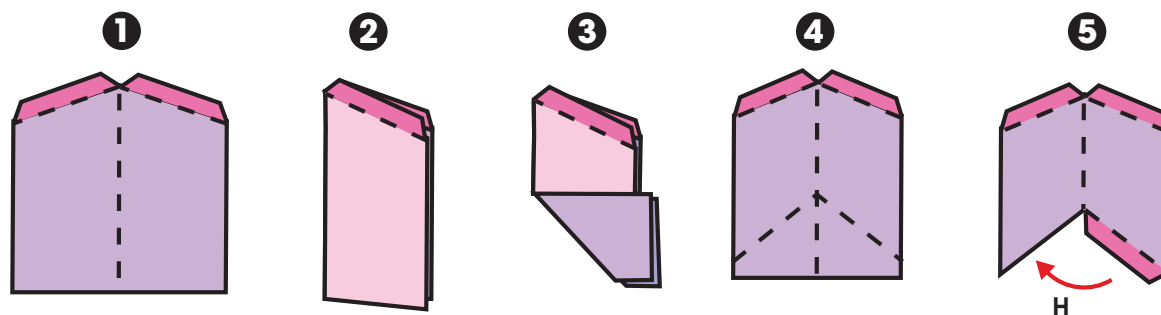

1 Make an Acute-angle V-fold (see page 32).

2 Fold it in half.

3 With the piece folded in half add an angled crease.

4 Unfold the piece.

5 Cut away one of the little triangles and trim the other into a gluing-tab.

6 Stick this tab, **H**, first. Ensure that the piece will fold flat.

7 Glue the piece to the base using the same method as for Foundation Shape 2 (see page 32). Before gluing, experiment with the angles between the tabs and the spine – the bigger the angle **G** between the gluing-tabs and the spine, the more the piece will move as the base closes.